



Alma Terrace, St. Leonards-On-Sea TN37 6QT

Offers in excess of £375,000



Charming FOUR BEDROOM end terrace VICTORIAN HOUSE set in a sought after location close to Silverhill and Alexandra Park. It's within immediate reach of popular primary schools, local shops and good transport links making it perfect for family life. The accommodation spans THREE STOREYS and is arranged as a bright, BAY FRONTED LIVING ROOM which enjoys generous proportions and is open to the dining room. The SEPARATE FITTED KITCHEN sits at the rear of the property and benefits from a conservatory with double doors leading out to the garden. There is also a handy downstairs cloakroom and UTILITY ROOM. The first floor houses THREE BEDROOMS, two of which are generous doubles, together with a family bathroom which offers a FREESTANDING BATH and separate shower. The upper floor has been converted to offer a further double bedroom with an EN-SUITE SHOWER ROOM and a large storage area. The rear garden enjoys an area of decking and a generous expanse of lawn with a GARDEN STUDIO/WORKSHOP and access at the rear. Benefitting from a DETACHED GARAGE to the rear which offers OFF ROAD PARKING for one.

GROUND FLOOR
611 sq.ft. (56.8 sq.m.) approx.

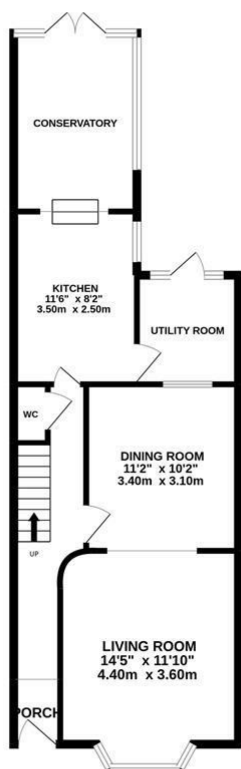

1ST FLOOR
464 sq.ft. (43.1 sq.m.) approx.



2ND FLOOR
192 sq.ft. (17.8 sq.m.) approx.

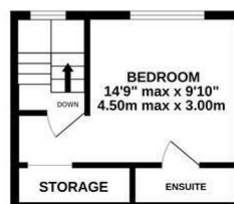

TOTAL FLOOR AREA: 1267 sq.ft. (117.7 sq.m.) approx.

Whilst every attempt has been made to ensure the accuracy of the floorplan contained here, measurements of doors, windows, rooms and any other items are approximate and no responsibility is taken for any error, omission or mis-statement. This plan is for illustrative purposes only and should be used as such by any prospective purchaser. The services, systems and appliances shown have not been tested and no guarantee as to their operability or efficiency can be given.
Made with Metropix ©2022

